



396-2792Y1

John Deere 1830 Stainless Steel Tube Installation Instructions

Kit Number: 270-1830



Step 1



Step 2

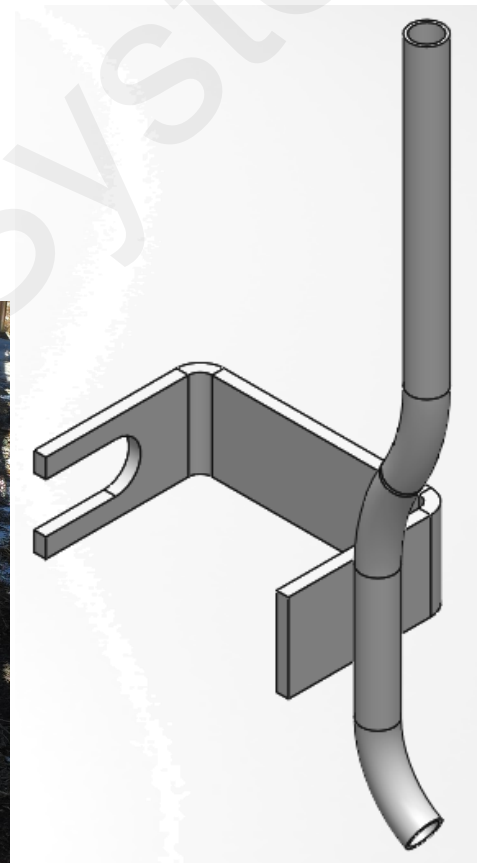

274-2791Y1

General Instructions:

1. Loosen flange nut enough to slip bracket behind the nut.
2. Position bracket as shown so placement tube is centered with shank.
3. Tighten flange nut.