



396-001370

Tank Mounting Instructions

3S4000 40' Drill

500 Gallon Elliptical Tank

Drill Manufacturer:



Kit Number:

551-04-200600: 500 Gallon

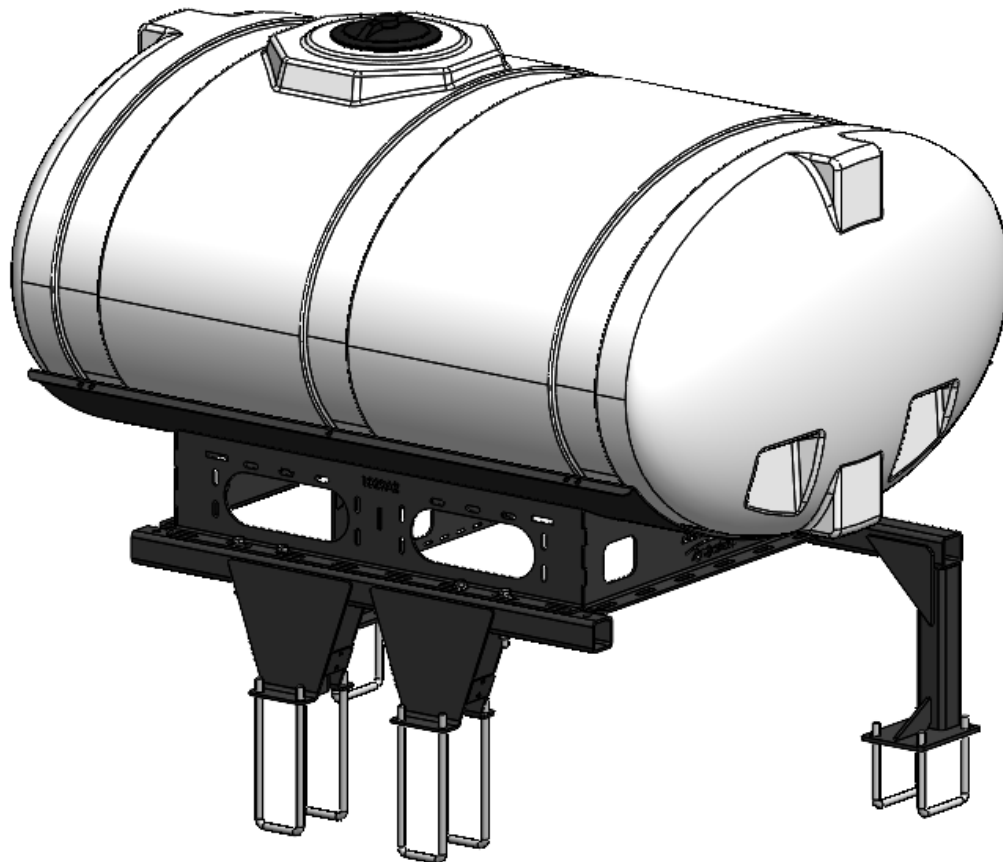



SurePoint Ag Systems

Fertilizer Tank Safety and Warnings



SurePoint Ag Systems does not recommend transporting your implement with full fertilizer tanks. Doing so can result in damage to brackets and implement.



Remember to wear proper PPE (*Personal Protective Equipment*) when installing SurePoint Ag Systems fertilizer tank kits. Proper PPE includes gloves, foot and eye protection, and hearing protection.



SurePoint Ag Systems fertilizer application systems require winterization when not in use. Refer to your product manual for winterization procedures.

Failure to follow the above warnings can result in personal injury, damage to your SurePoint Ag Systems products, and damage to your implement.



Parts List and Exploded View

ITEM NO.	PART NUMBER	DESCRIPTION	QTY.
1	727-01-HE0500-57-CS-W	Elliptical Tank - 500 Gal - White - Center Sump	1
2	421-1329A2	500 Gallon Elliptical Black Cradle	1
3	450-1063A2	Great Plains 40' Front Bracket	1
4	450-1058A1	Rear Bracket WA 30' & 40' Great Plains	1
5	300-100500-5	5/8" x 5" Hex Head Bolt - G5	8
6	331-10	5/8" Lock Washer	8
7	330-10	5/8" Flat Washer	16
8	320-10	5/8" Nut	8
9	380-1044	5/8" U-Bolt Kit - Fits 4" x 12" Tube (4" Opening)	4
10	380-1042	5/8" U-Bolt Kit - Fits 6" x 6" Tube (6" Opening)	4
11	380-1040	5/8" U-Bolt Kit - Fits 7" x 7" Tube	4
12	525-3000	3" Tank Strap Kit for 400 - 750 Gal Tanks	3
13	521-00-100285	Tank Overflow Assembly Bag for 400-750 Gal Tanks	1
14	280-100-AG200	1" AG200 Bulk	10'

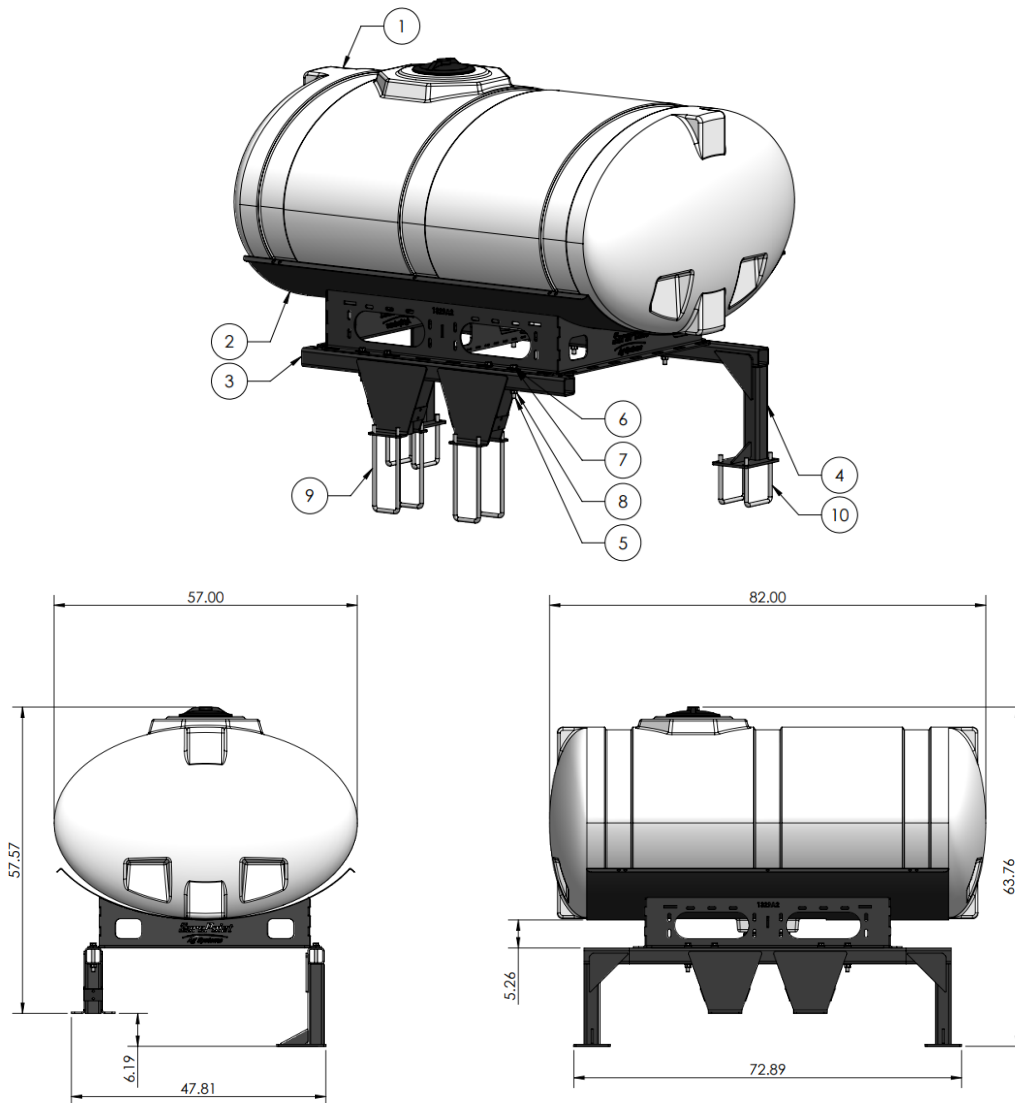



Step by Step Instructions

1. Loosely u-bolt rear stand to drill, centered on the center drill box. Note that vertical tubes are offset to the rear of the drill.
2. Loosely u-bolt front stand to drill in location shown.

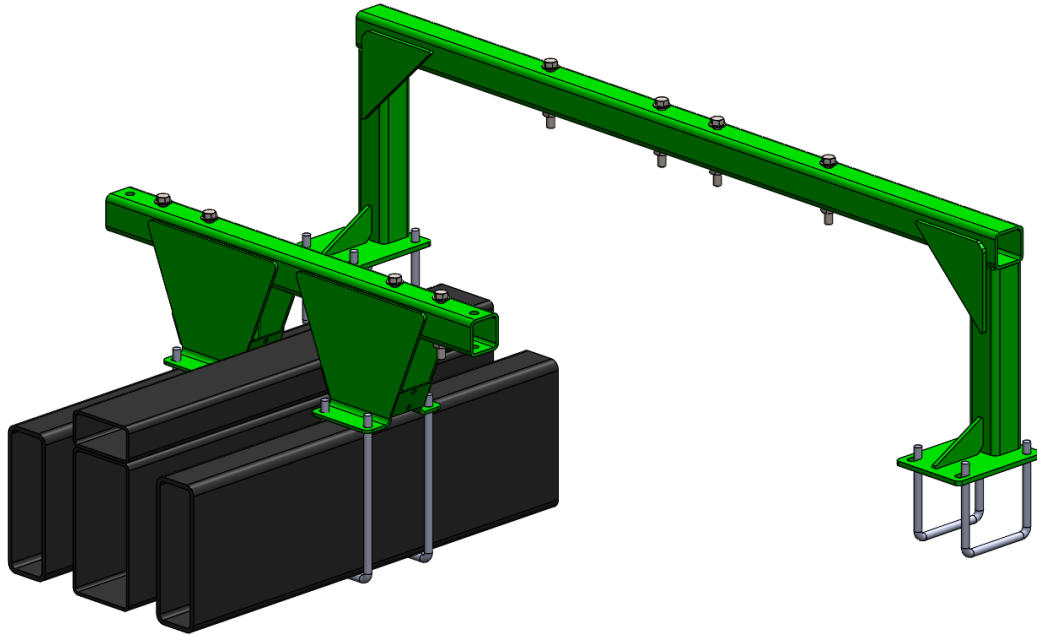

3. Set cradle on stands and bolt down using 5/8" bolts in locations shown above. The front stand may be adjusted forward or backwards as necessary.
4. Once cradle is in place, tighten all bolts.
5. Set and strap tank in place on cradle.

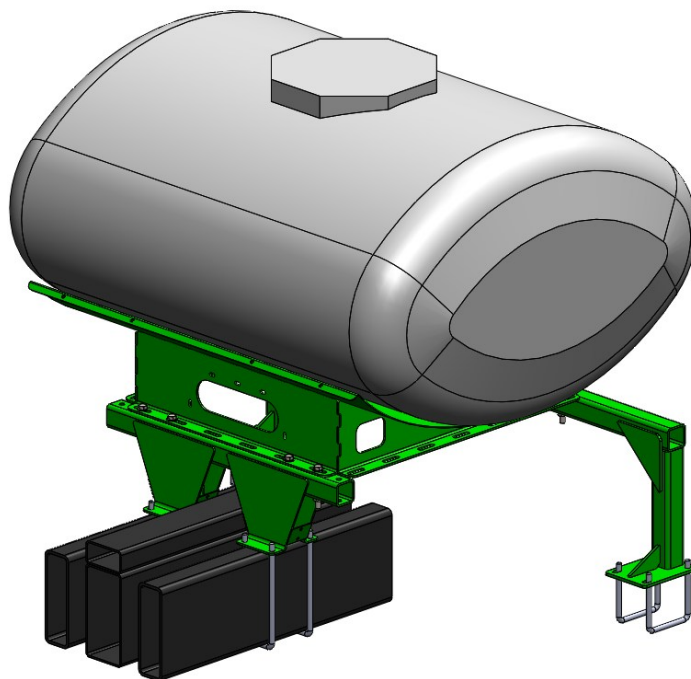



Step by Step Instructions

In some cases, the wing folding cylinders may be in the way or interfere with the Front Tank Bracket (450-1063A2) mounting position. Move the bracket back and fasten to the side slots on the Tank Cradle (421-13A2). See Diagram below...





Optional/Related Items

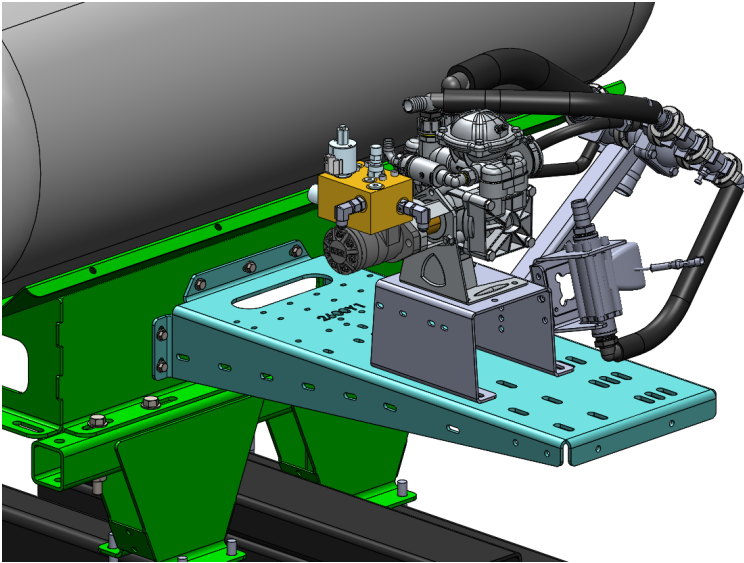

PumpRight Bracket Kit
Kit Number: 515-203200
Instruction sheet: 396-2613Y1

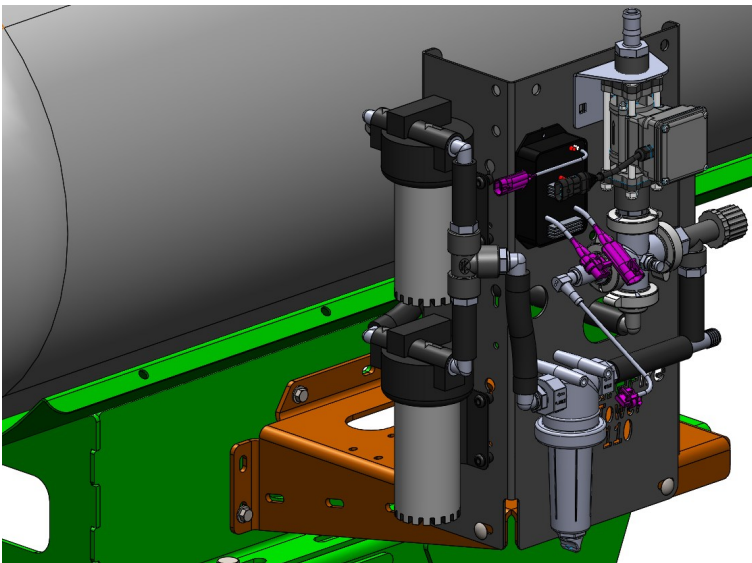

Tower Bracket Kit
Kit Number: 511-100850
Instruction sheet: 396-2648Y1

Tank Fill Kit: 555-101350
Tower Discharge Kit: 556-1001
PumpRight Discharge Kit: 520-00-103600

Instruction Sheet: 396-2645Y1



Optional/Related Items

Manifold Kits:

Instruction sheet for this kit: **396-2618Y1**

553-04-40000: 40' 7.5" spacing

553-04-40500: 40' 10" spacing

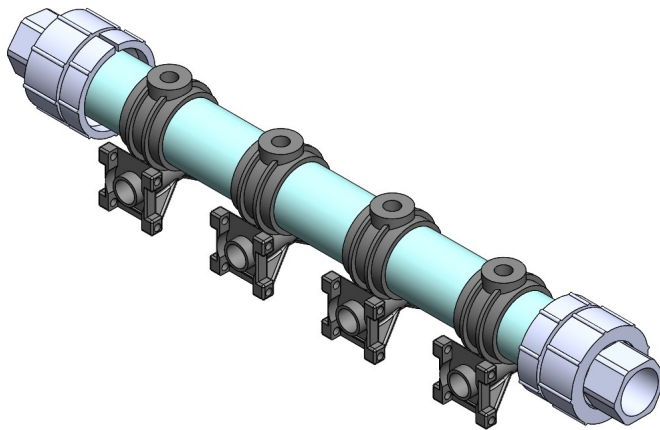

Stainless Steel Tubes:

270-54HD (shown at left)

270-54

270-GP10SERIESHD

Note: When tubes are installed on the HD openers, the seed flapper must be removed.