



396-001190

Tank Mounting Instructions

400 and 500 Gallon Elliptical Tank

Sunflower 9434

Drill Manufacturer: **SUNFLOWER**

Kit Numbers:

551-01-100500: 400 Gallon

551-01-100750: 500 Gallon

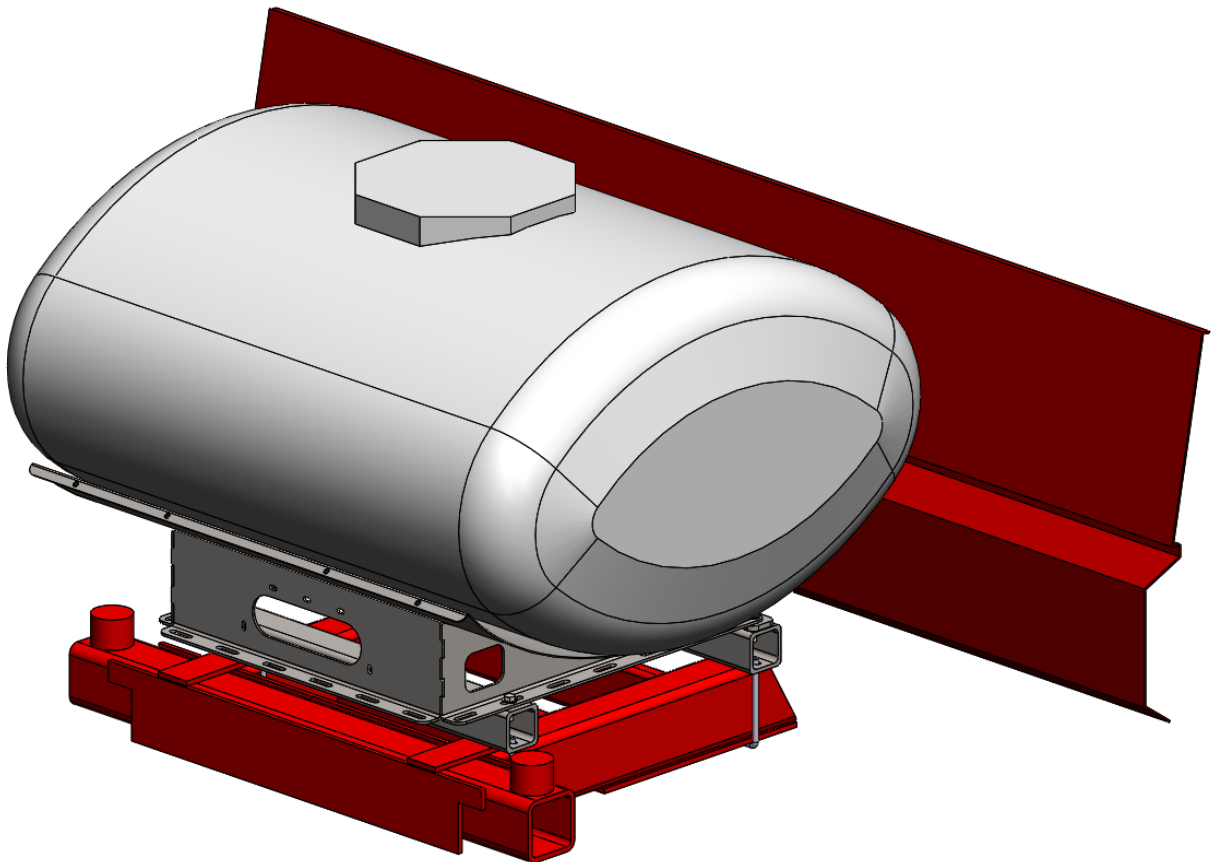



SurePoint Ag Systems Fertilizer Tank Safety and Warnings



SurePoint Ag Systems does not recommend transporting your implement with full fertilizer tanks. Doing so can result in damage to brackets and implement.



Remember to wear proper PPE (*Personal Protective Equipment*) when installing SurePoint Ag Systems fertilizer tank kits. Proper PPE includes gloves, foot and eye protection, and hearing protection.



SurePoint Ag Systems fertilizer application systems require winterization when not in use. Refer to your product manual for winterization procedures.

Failure to follow the above warnings can result in personal injury, damage to your SurePoint Ag Systems products, and damage to your implement.



Parts List and Exploded View

551-01-100500: 400 Gallon

ITEM NO.	PART NUMBER	DESCRIPTION	QTY.
1	727-01-HE0400-57-W	Elliptical Tank - 400 Gal - White	1
2	421-1333A2	400 Gallon Elliptical Black Cradle	1
3	421-1331A1	4" Tube for Sunflower 9434 400 Gallon Tank Mounting	2
4	421-1332A1	Spacer for Sunflower 9434	2
5	300-100200-5	5/8" x 2" Hex Head Bolt - G5	2
6	300-100208-5	5/8" x 2-1/2" Hex Head Bolt - G5	2
7	330-10	5/8" Flat Washer	4
8	323-10	5/8" Flange Nut	4
9	380-1014	1/2" U-Bolt Kit - Fits 5" x 7" Tube (5" Opening)	4
10	525-3000	Tank Strap Kit, 3" Wide, 400-750 Gallon	2
11	521-00-100285	Tank Overflow Assembly Bag for 400-750 Gallon Tanks	1
12	280-100-AG200	1" AG200 Bulk	10'

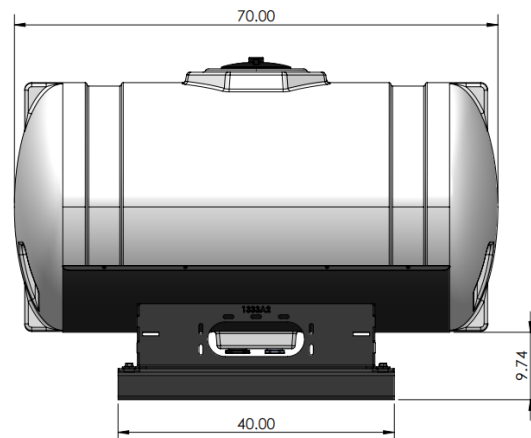
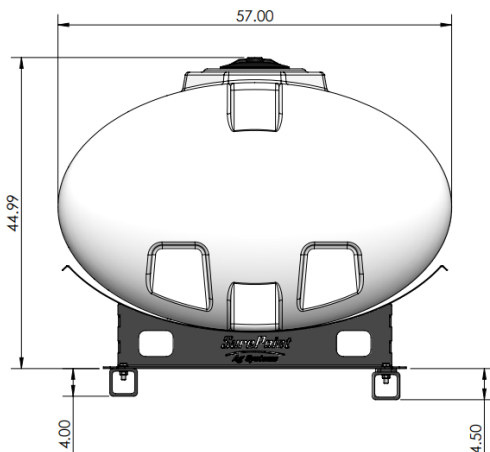
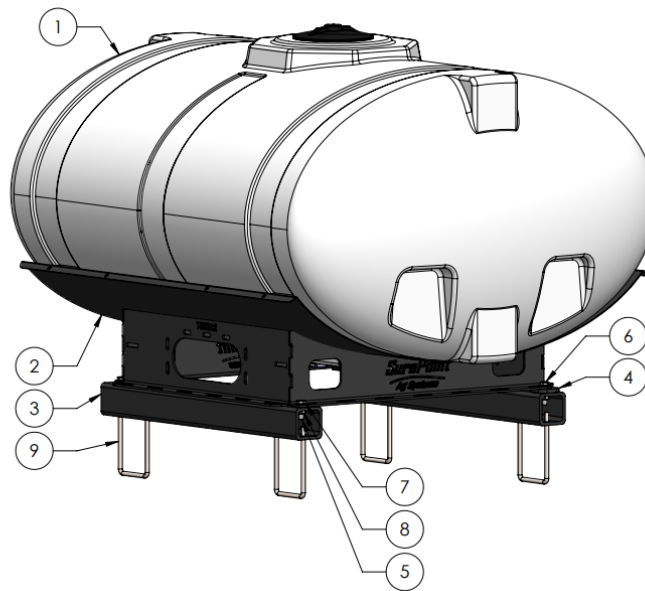



Parts List and Exploded View

551-01-100750: 500 Gallon

ITEM NO.	PART NUMBER	DESCRIPTION	QTY.
1	727-01-HE0500-57-CS-W	Elliptical Tank - 400 Gal - White	1
2	421-1329A2	500 Gallon Elliptical Black Cradle	1
3	421-2097A1	4" Tube for Sunflower 9434 500 Gallon Tank Mounting	2
4	421-1332A1	Spacer for Sunflower 9434	2
5	300-100200-5	5/8" x 2" Hex Head Bolt - G5	2
6	300-100208-5	5/8" x 2-1/2" Hex Head Bolt - G5	2
7	330-10	5/8" Flat Washer	4
8	323-10	5/8" Flange Nut	4
9	525-3000	Tank Strap Kit, 3" Wide, 400-750 Gallon	3
10	521-00-100285	Tank Overflow Assembly Bag for 400-750 Gallon Tanks	1
11	380-1029	1/2" U-Bolt Kit - Fits 5" x 11-1/2" Tube (5" Opening)	4
12	280-100-AG200	1" AG200 Bulk	10'

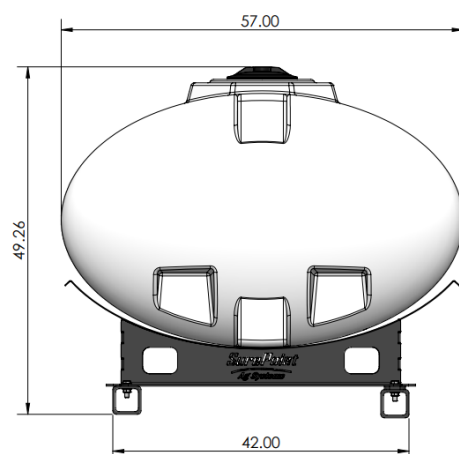
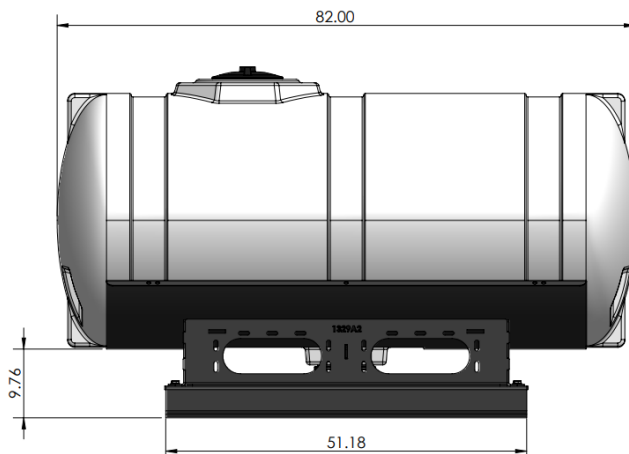
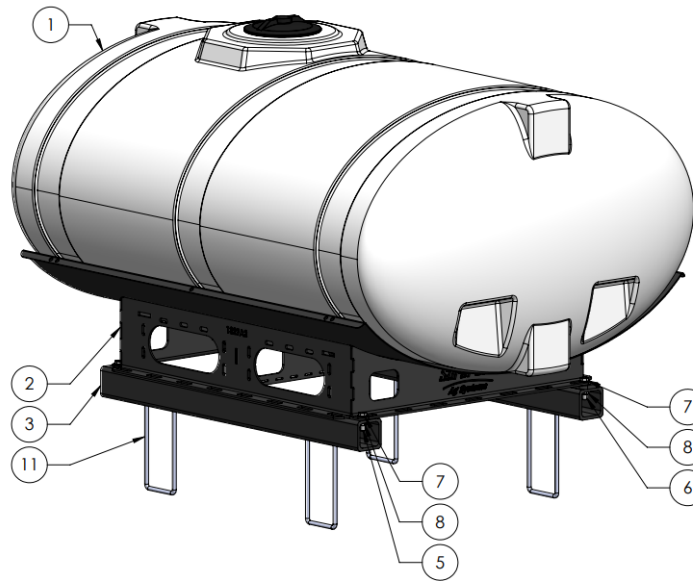



Step by Step Instructions

1. Loosely U-bolt the 4"x4" supports across the frame of the drill in front of the center section.
2. Set spacers on rear support. The spacers are necessary to have the tank set level with the drill frame.

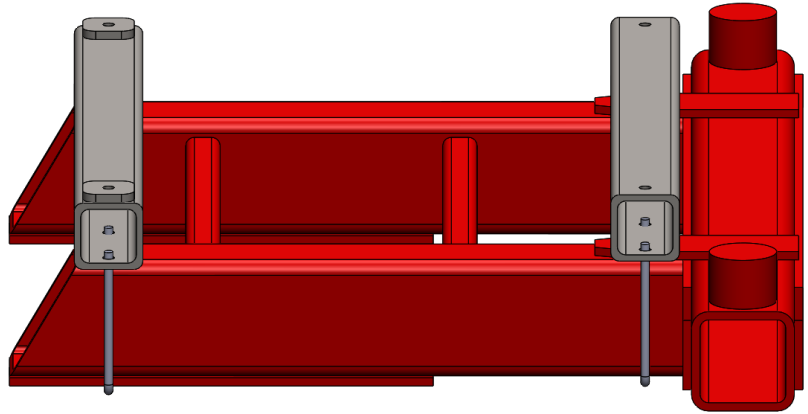

3. Set the tank cradle on the 4"x4" supports. Bolt down with 5/8" bolts (2" bolts in the front, 2-1/2" bolts in the rear), washers, and flange nuts.
4. Set and strap tank into place on the cradle. Open the center section lid to ensure that the tank does not interfere with the lid opening.
5. Tighten down U-bolts from step 1.



Optional/Related Items

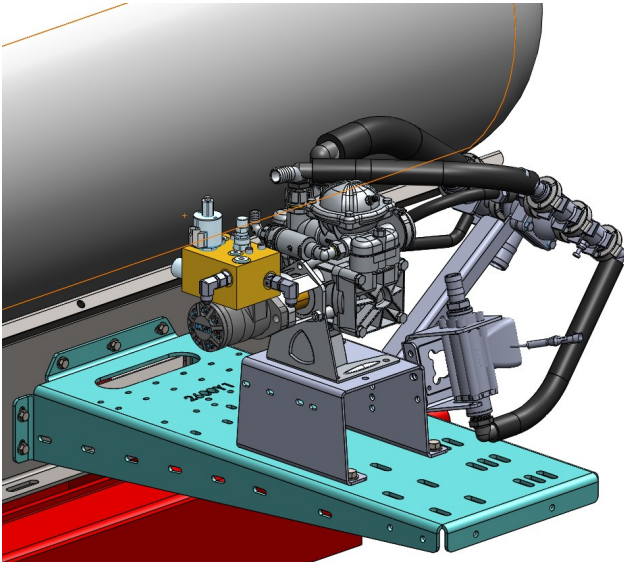

PumpRight Bracket Kit
Kit Number: 515-203200
Instruction sheet for this kit:
396-2613Y1

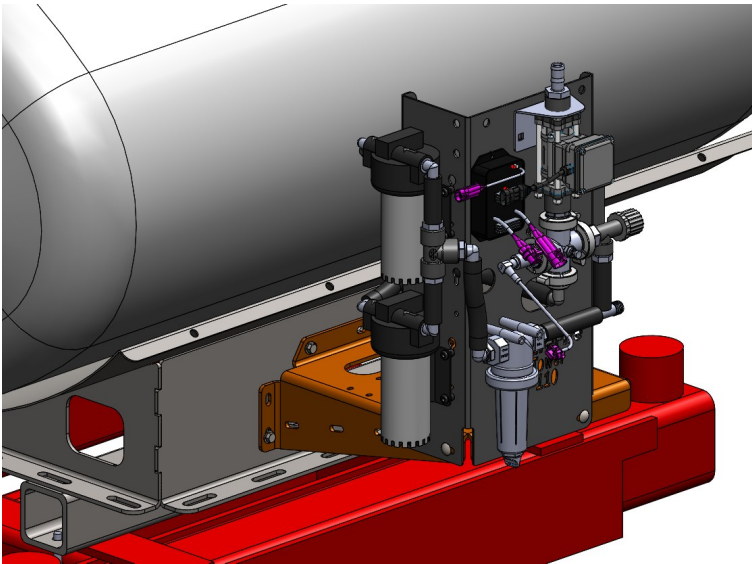

Tower Bracket Kit
Kit Number: 511-100850
Instruction sheet for this kit:
396-2648Y1

Tank Fill Kit: 555-101350
Tower Discharge Kit: 556-1001
PumpRight Discharge Kit: 520-00-103600

Instruction Sheet: 396-2645Y1



Optional/Related Items

Manifold Kit Numbers:

Instruction sheet for these kits: 396-2619Y1

553-01-30000: 30' 7.5" spacing

553-01-30500: 30' 10" spacing

553-01-40000: 40' 7.5" spacing

553-01-40500: 40' 10" spacing

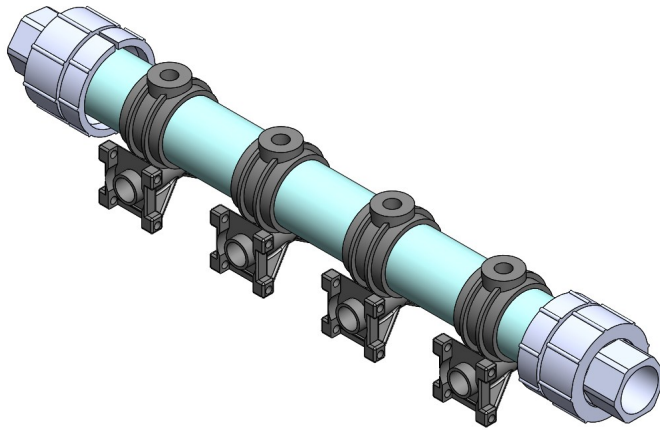

Stainless Steel Tubes:

270-1242A1 (shown below)

270-9431-96

